

CODE	MODEL	TYPE	POWER SUPPLY	SERIES
935471	PQE200I	BOILING PAN	ELECTRIC	SPECIAL EQUIPMENTS

DESCRIPTION

ELECTRIC BOILING PAN 200L INDIRECT HEATING
TECHNICAL DATA

Electric power (kW)	32
Standard voltage* (kW)	415V/3N/50-60Hz
N° of cooking zones	1x220lt
Tank height (mm)	520
Cooking tank diameter (mm)	750
N° of tanks	1x220lt
IPX Protection Grade (mm)	IPX4

DIMENSIONS DATA

Product dimensions (mm)	1000W x 1150 P x 900 H
Gross weight (kg)	290
Packaging volume (m3)	1.9

CONSTRUCTIONAL FEATURES

Cooking tank with bottom in stainless steel AISI 316 (thickness 20-25/10) specifically intended for the processing of particularly acid products, and walls in stainless steel AISI 304 (thickness 20/10). Balanced lid in stainless steel AISI 304 (thickness 12-15/10) with athermic handle. Supporting structure in stainless steel AISI 430 (thickness 15-20/10). Heat insulation guaranteed by panels in thick glass fibre. Cover in stainless steel AISI 304, fine satin finish (thickness 10/10). Adjustable feet in stainless steel AISI 304 to ensure levelling.

TECHNICAL FEATURES

Heating by means of armoured elements in INCOLOY-800 alloy, controlled by electromechanical thermostat. Safety valve at 0,5 bar, vacuum valve and analogic pressure gauge. Vat filled with water by means of tap (hot/cold water) and swivel hose. Exhaust hole of vat with filter (extractable). Front drain cock 2 inc., (1 inc 1/2 for 50 l. model) in chrome-plated brass with insulating handle. ON/OFF switch. Water favcet (hot/cold water). Jacket level front control cock. Temperature setting with electromechanical thermostat and min/max selector. Tank front drain cock. Visible signal in case of lowest water level in jacket. Visible signal to interrupt heating system due of lowest water level in jacket. Heating operating visual alarm. Jacket safety valve at 0.5 bar. Jacket vacuum valve. Blocking of heating for excess of temperature with manual resettable safety thermostat.

ACCESSORIES(not included)

Code	Model	Description
861833	CPS202	2 STAINLESS STEEL BASKETS 1/2
861839	CPS302	2 STAINLESS STEEL BASKETS 1/2
861840	CPS502	2 STAINLESS STEEL BASKETS 1/2
861853	CPS203	3 STAINLESS STEEL BASKETS 1/3
861859	CPS303	3 STAINLESS STEEL BASKETS 1/3
861865	CPS503	3 STAINLESS STEEL BASKETS 1/3
861959	K200	STAINLESS STEEL COUSCOUSIERE
861965	K300	STAINLESS STEEL COUSCOUSIERE

CODE	MODEL	TYPE	POWER SUPPLY	SERIES
935471	PQE200I	BOILING PAN	ELECTRIC	SPECIAL EQUIPMENTS

DESCRIPTION

ELECTRIC BOILING PAN 200L INDIRECT HEATING

TECHNICAL DRAWING

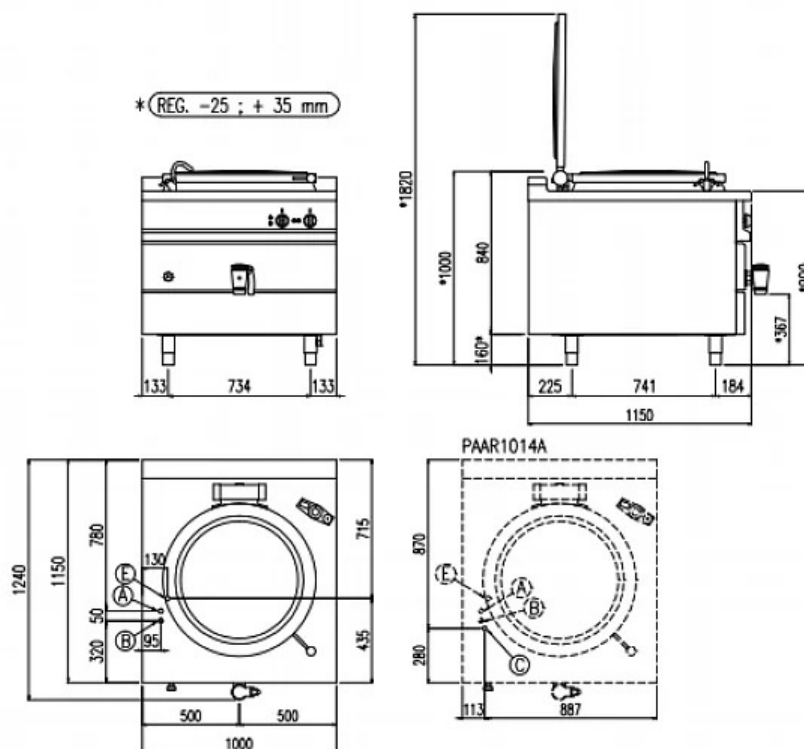

CONNECTIONS

E = ELECTRIC	415V/3N/50-60Hz
W = WATER INLET	ø1/2"
F = COLD WATER INLET	ø1/2"