

CODE	MODEL	TYPE	POWER SUPPLY	SERIES
<b>80300684</b>	<b>BRBT703-6C</b>	<b>REFRIGERATED COUNTER</b>	<b>ELECTRIC</b>	<b>MILO REFRIGERATION</b>

## DESCRIPTION

**COUNTER FREZ. 1600 2+2+2 DRAWERS + TOP -24/-10°C BUILT-IN CONDENSING UNIT**

## TECHNICAL DATA

Electric power (kW)	0.353
Standard voltage* (kW)	230/1/50
N° of tanks	6 (5l 165x360xH120 mm)
Power absorbed (Amp)	6.2
Refrigerating power (W)	445
IPX Protection Grade (mm)	IPX4
Insulation thickness (mm)	50
Noise (db) 5m	50
Daily energy consumption (kWh)	10
Annual energy consumption (kWh/annum)	3560
Climate class	5
Energy efficiency class	G
Compressor	NEU2155U
Controller	EV3B
Temperature range	-24/-10°C



## DIMENSIONS DATA

Product dimensions (mm)	1600W x 685 P x 624 H
Internal dimensions (mm)	325x530x250
Net weight (kg)	117
Gross weight (kg)	143
Packaging dimensions (m3)	1620 x 705 x 700
Packaging volume (m3)	129.12

## CONSTRUCTIONAL FEATURES

Stainless steel AISI 304 ventilated refrigerated counters on feet or castors. 700 mm of depth, body height H 443 mm; 2 or 3 doors GNI/1 with full (mod. 2C or 3C) or 1/2 drawers (mod. 4C or 6C) per door with full extraction drawers. Built unit, versions with straight worktop H40mm or without top (mod. LI). Digital controller. Inner bottom panel with rounded corners. Automatic systems for defrosting and evaporation of the condensation water.

## ACCESSORIES(not included)

Code	Model	Description
80300706	4W_COUNTER	CASTORS KIT FOR REFRIG. COUNTER
80300707	SV_COUNTER	SUPPL. SPECIAL VOLTAGE 220V/6Hz ONLY FOR REFRIGERATED COUNTER

CODE	MODEL	TYPE	POWER SUPPLY	SERIES
<b>80300684</b>	<b>BRBT703-6C</b>	<b>REFRIGERATED COUNTER</b>	<b>ELECTRIC</b>	<b>MILO REFRIGERATION</b>

DESCRIPTION

**COUNTER FREZ. 1600 2+2+2 DRAWERS + TOP -24/-10°C BUILT-IN CONDENSING UNIT**

TECHNICAL DRAWING

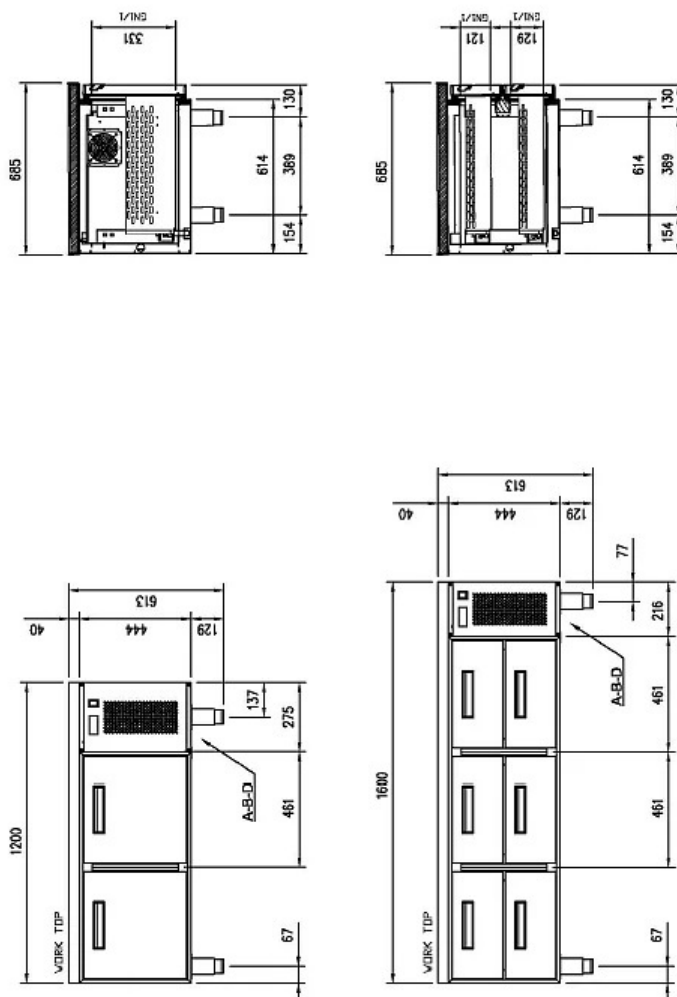

CONNECTIONS

G = GAS	R290 - GWP 3 - Kg 0,090
E = ELECTRIC	230/1/50